

JUNE 2019

ETF

News



42

imaginative engineering

IN THIS NUMBER

ETF Machinefabriek participates in ITMA Barcelona 2019

ETF presents versatile rolling machine at ITMA

One man operated cut length machine

New end of a carpet backing line for the Middle East

ETF Machinefabriek participates in ITMA Barcelona 2019



ITMA SPECIAL

See us at booth H1.C205

Production machines

Cutting and finishing

Logistic systems

Cutting and measuring systems

Special machines

The ETF stand crew during ITMA Barcelona
From left to right: David Huls, Ruud Jeen, Bart van den Brand and Ruud Koppens

This world leading exhibition will take place from 20th-26th June 2019 in Barcelona, Spain. For us, ITMA is an excellent opportunity to show off our latest technology and innovations and meet with (new) customers. The ETF sales team would like to welcome you in our booth in **Hall 1, booth no. C205**



Dear Reader,

ITMA 2019 is quickly approaching. After Milan in 2015, we are going back to Barcelona for this edition. It will be the 12th time that ETF is present during an ITMA show and we are really looking forward to it.

In Barcelona, ETF will be presenting a versatile rolling machine as its main product for this show. It is a non-woven rolling machine, but the technology can also be applied to, for example, carpet and artificial grass. Our sales team can tell you all about this machine and, of course, all about our other products and latest developments as well.

You can also read about some recent projects such as a new finishing line, an automatic roll-up and wrapping system in Abu Dhabi, and the latest cut-order machine provided to a Dutch customer, of which we are naturally very proud.

Recently, the holding company that owns ETF has taken an interest, as largest of three shareholders, in the new Sellers Textile Engineering company in the UK. The product ranges are complementary in certain areas. Both companies will continue their activities independently of each other.

In the meantime, ETF is expanding considerably to meet all our demands. In fact, we have increased our team by around 10 new employees in the last 12 months and have also expanded our business premises and the factory meaning that ETF is absolutely ready for the future.

I hope you enjoy reading this newsletter and we would very much like to welcome you at our booth during ITMA 2019!

Ruud Koppens, President



Production machines



Cutting and finishing



Logistic systems



Cutting and measuring systems



Special machines



Versatile rolling machine M 5728

During the upcoming ITMA exhibition in Barcelona, ETF will be showing its new rolling machine type M 5728 which can roll a broad range of materials. ETF's engineers have designed this machine in a modular way so that it can be equipped with various options that enable it to be adapted to the material to be rolled and the customers' requirements. Even switching between different options without the need of (partly) rebuilding the machine is possible.

ETF presents versatile rolling machine at ITMA

This versatile rolling machine, which is being shown during the ITMA is, among other innovative features, equipped with centre drives. This function guarantees the creation of very tight rolls, which is very interesting for clients when rolling items such as non-wovens or artificial grass. After the material is fixed to the core by e.g. staples, a driven head will move into the core at both sides and then pneumatically expand to hold it. An intelligent operating system controls the speed of the individual main rollers and the expanded heads so that the maximum torque can be applied at the beginning of the rolling process in order to give the roll a tight start. Then as the roll diameter, and thus the weight of the roll increases, less torque is required to maintain a tight roll.

The model of the versatile rolling machine being shown is also equipped with a double driven cross cutter. Thanks to direct driving of both the upper and top circular knife, a broad range of material thicknesses can be cut without holding or damaging the material. Furthermore a small layer of glue can be applied on the starting edge of the new roll during cross cutting. By rolling the material a little in the reverse direction, it will then be attached to the core automatically, after which rolling the next roll can be started without any operator intervention.

Some of the other options that the new rolling machine can be equipped with are:

- a push roller system in order to create tight and straight edged rolls, even when the material is slit (not shown);
- easily adjustable main rollers in order to be able to work with a large variety of tubes and/or roll diameters;
- an automatic tube dispenser (not shown) in order to start rolling fully automatically without operator intervention (in combination with the glue system);
- and an optical length measuring system to measure with an accuracy of more than 0.15%.

If you visit the ETF booth H1-C205 during the ITMA, we would be very happy to tell you all about the possibilities of the versatile rolling machine and how it can enhance your production process. Information about all other ETF machine concepts, related to inspection, rolling, wrapping, roll transport and sorting, can also be found at our booth.

ETF recently manufactured a new state of the art, cut length machine type M 5630 with an additional small roll sorting system for one of its much appreciated Dutch customers. Thanks to the cut length machine, the customer will now be able to cut all floor covering orders sold through their more than 100 stores on a daily basis.

One man operated cut length machine

Since the roll ends are not closed, the machine can be operated by just one operator, standing on the operator platform at the unrolling cradle. A label, indicating among other things the roll destination, is applied automatically to every wrapped cut length by a label applicator. This applicator was supplied by the customer and was mechanically and electrically integrated with the cut length machine by ETF.

Next to a fully automated supply and discharge table for parent rolls, the cut length machine was supplied with various features including a laser length measuring system to measure with an accuracy of better than 0.15%. The use of a laser instead of a conventional measuring wheel means that the measuring is not influenced by the mass moment of inertia, slip or dirt on the contact surface. The cut length machine was also equipped with an automatic turning system to turn small cut lengths over 90° in order to save wrapping foil and

transport volume. Furthermore a slitting knife was installed for the customer to create greater flexibility regarding the flooring dimensions ordered by their customers.

Rolling and wrapping the cut lengths is done fully automatically and can be monitored by the operator through a camera system. After a label is applied to the roll, it will be automatically sorted so as to go to the set destination wagon. Once a wagon is completely full, an alarm is automatically generated to inform the operator that the wagon must be exchanged.

The ETF cut length machine was supplied as 'safe to operate' according to the latest CE safety directives. This means that if, for example, an operator enters the area around the unrolling cradle or the rolling unit the machine, all movements by the air cylinders are stopped.

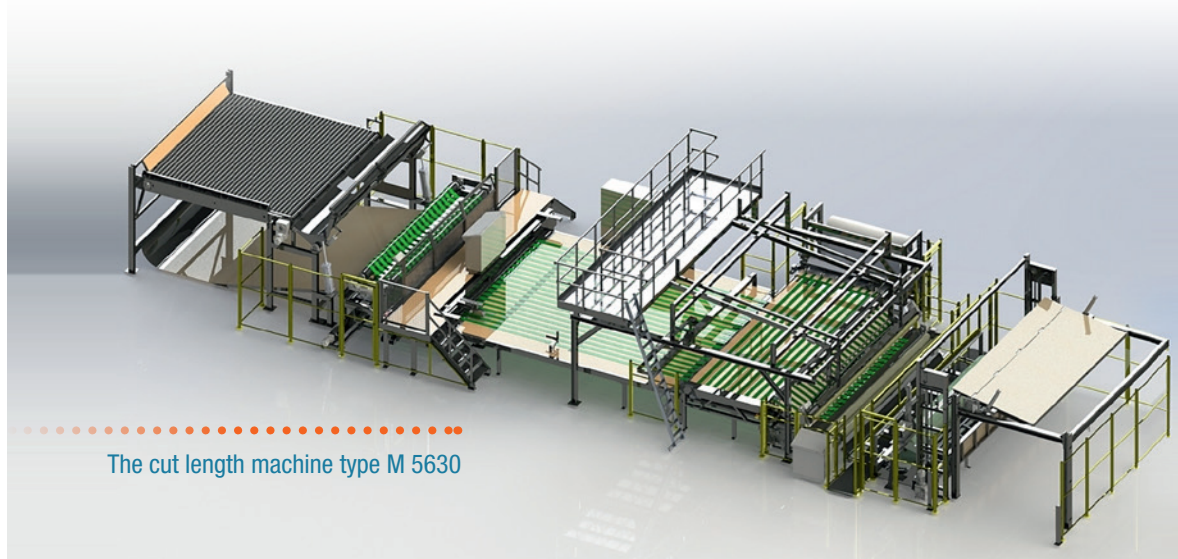

The cut length machine type M 5630

Visit us at booth Hall 1 / C205

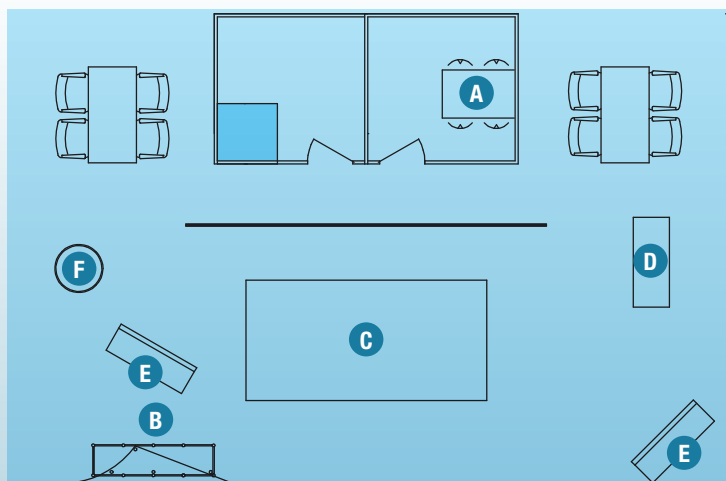

Stand map

- A** Office
- B** Information desk
- C** Versatile rolling machine M 5728
- D** Cutting systems presentation
- E** Video presentation
- F** Presentation column

New end of a carpet backing line for the Middle East

A valued Middle East customer which wanted to modernise its facilities recently installed a new ETF Outlet backing line with automatic M 5724 roll up unit, automatic tube supply, and automatic wrapping system.



The new end of a carpet backing line M 5300

Of course several options, such as slitting and contact free length measuring by laser, were also included. This new outlet line was installed behind their existing backing line last month.

The line will be suitable for handling trimmed material widths ranging from 3,660 mm up to 4,000 mm with a maximum production speed of 15 m/min.

The main reason that the customer choose to purchase a new ETF system was to avoid any carpet destruction at the roll start in the future. They had seen ETF's experience in this field, e.g. with the soft-start option that ETF has within their rolling systems, and so awarded ETF the order for this project.

We were also challenged to synchronise this with an existing line, as well as installing it in the tight space available. Furthermore, it also had to fit behind a high spread coater which is being planned for the future.

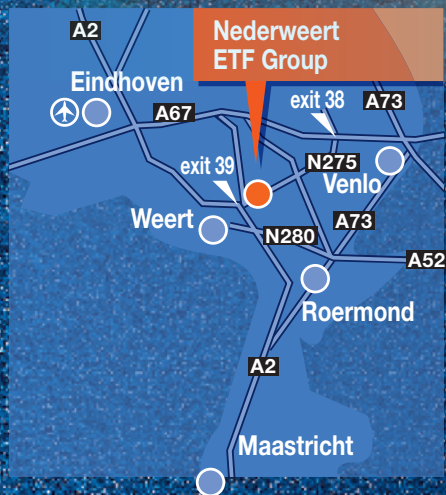

ETF Machinefabriek B.V.

P.O. Box 2703
 6030 AA NEDERWEERT, the Netherlands
 Phone +31 (0)495 677000
 Fax +31 (0)495 632323
 E-mail sales@etf.nl

ETF-USA Corporation

P.O. Box 2506
 DALTON, GA 30722, USA
 Phone +1 (706) 278 1511
 Fax +1 (706) 278 3511
 E-mail harrell@windstream.net



imaginative engineering